

▼ Shown from left to right: CLRG-506, CLRG-4006, CLRG-2506 shown with optional collar threads

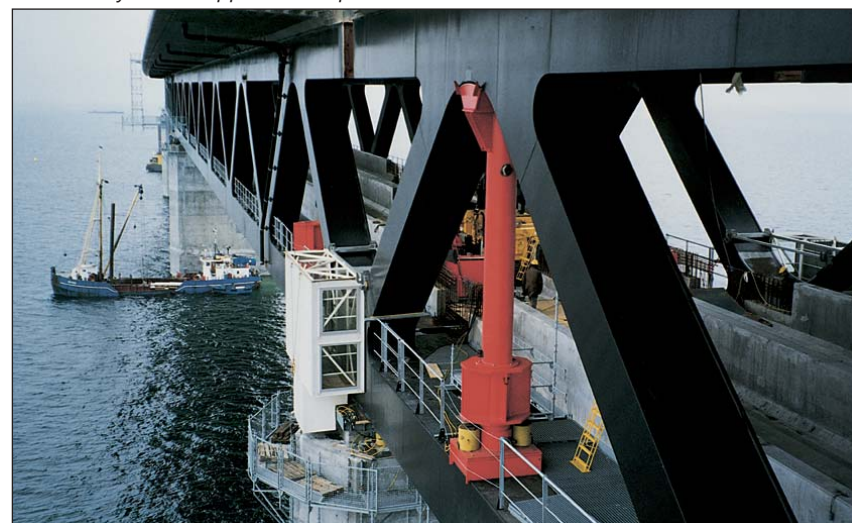

- Integral stop ring provides piston blow-out protection
- Double-acting for positive retraction
- Baked enamel outside finish and plated pistons provide superior corrosion resistance
- Special bearing design withstands sideload forces up to 10% of rated cylinder capacity without scoring
- Safety valve in retract side of cylinder helps to prevent damage in case of accidental over-pressurization
- Interchangeable, hardened grooved saddles are standard
- Plunger wiper reduces contamination ingress, extending cylinder life

▼ CLRG-cylinders supported and positioned these automobile deck elements.



Double-Acting Power Lifters



Saddles

All CLRG cylinders are equipped with bolt-on removable grooved saddles. For information on optional tilt saddles, see selection chart.

Page: 41



Safety Device

A pilot-operated check valve (V-42) can be inserted between cylinder ports. This valve provides a safety lock

on the cylinder under load at any position and remote control for unlocking.

Page: 132



Optimum Performance

Enerpac's range of Hushh electric pumps, fitted with manual or solenoid operated 4-way valves, offer optimum combinations with CLRG cylinders.

Page: 82



Standard Features

- Interchangeable, hardened grooved saddles
- CR-400 Coupler and dust cap
- Top and side mounted lifting eyes
- All cylinders meet PREN 1494, ANSI B-30.1 and ISO 10100 Standards

▼ Replacing adjustment rolls under a fly-over with CLRG cylinders, for controlled lifting and lowering.



CLRG Series



Capacity:

50-1,000 tons

Stroke:

1.97-11.81 inch

Maximum Operating Pressure:

10,000 psi



Pump Selection

A double-acting cylinder must be powered by a pump with a 4-way valve.

Page: 57



RR-series

For higher cycle applications, Enerpac RR-cylinders are a good alternative.

Page: 26



Additional Stroke Lengths

Models above 150 tons are also available with standard stroke lengths of 4, 8 and 10 inches. Please contact Enerpac for ordering information.



Optional feature

Collar threads are available as an optional feature on your cylinders by adding E002 to the end of the model number.

Collar threads

E002

Example:

- For CLRG-5006 cylinder with collar threads, order: **CLRG-5006 E002**

Technical specifications for this feature are available from Enerpac.

▼ QUICK SELECTION CHART

For complete technical information see next page.

Cylinder Capacity (tons) Nominal [maximum]	Stroke (in)	Model Number	Cylinder Effective Area (in ²)		Oil Capacity (in ³)		Collapsed Height (in)
			Push	Pull	Push	Pull	
50 [59]	1.97	CLRG-502	11.81	5.85	23.25	11.51	6.38
	3.94	CLRG-504	11.81	5.85	46.50	23.02	8.35
	5.91	CLRG-506	11.81	5.85	69.75	34.52	10.31
	7.87	CLRG-508	11.81	5.85	93.00	46.03	12.28
	9.84	CLRG-5010	11.81	5.85	116.25	57.54	14.25
100 [103]	1.97	CLRG-1002	20.57	9.59	40.50	18.87	7.16
	3.94	CLRG-1004	20.57	9.59	81.00	37.74	9.13
	5.91	CLRG-1006	20.57	9.59	121.50	56.61	11.09
	7.87	CLRG-1008	20.57	9.59	162.00	75.49	13.06
	9.84	CLRG-10010	20.57	9.59	202.50	94.36	15.03
150 [154]	1.97	CLRG-1502	30.78	14.96	60.58	29.44	7.72
	3.94	CLRG-1504	30.78	14.96	121.17	58.88	9.69
	5.91	CLRG-1506	30.78	14.96	181.75	88.32	11.65
	7.87	CLRG-1508	30.78	14.96	242.33	117.76	13.62
	9.84	CLRG-15010	30.78	14.96	302.92	147.20	15.59
200 [206]	1.97	CLRG-2002	41.22	19.68	81.13	38.74	8.50
	5.91	CLRG-2006	41.22	19.68	243.40	116.23	12.44
	11.81	CLRG-20012	41.22	19.68	486.79	232.46	18.35
	1.97	CLRG-2502	56.80	23.65	111.81	46.56	9.25
	5.91	CLRG-2506	56.80	23.65	335.42	139.69	13.19
250 [284]	11.81	CLRG-25012	56.80	23.65	670.84	279.39	19.09
	1.97	CLRG-3002	70.71	23.46	139.19	46.18	12.28
	5.91	CLRG-3006	70.71	23.46	417.56	138.55	16.22
300 [354]	11.81	CLRG-30012	70.71	23.46	835.11	277.10	22.13
	1.97	CLRG-4002	86.79	29.99	170.84	59.03	14.74
400 [434]	5.91	CLRG-4006	86.79	29.99	512.51	177.09	18.68
	11.81	CLRG-40012	86.79	29.99	1025.02	354.18	24.59
	1.97	CLRG-5002	113.25	38.37	222.92	75.54	16.50
500 [566]	5.91	CLRG-5006	113.25	38.37	668.77	226.61	20.43
	11.81	CLRG-50012	113.25	38.37	1337.55	453.22	26.34
	1.97	CLRG-6002	132.57	45.79	260.97	90.13	16.89
600 [663]	5.91	CLRG-6006	132.57	45.79	782.90	270.39	20.83
	11.81	CLRG-60012	132.57	45.79	1565.81	540.79	26.73
	1.97	CLRG-8002	182.32	59.99	358.91	118.09	18.66
800 [912]	5.91	CLRG-8006	182.32	59.99	1076.72	354.28	22.60
	11.81	CLRG-80012	182.32	59.99	2153.44	708.57	28.50
	1.97	CLRG-10002	227.19	83.97	447.23	165.29	22.20
1000 [1136]	5.91	CLRG-10006	227.19	83.97	1341.68	495.87	26.14
	11.81	CLRG-100012	227.19	83.97	2683.35	991.75	32.05

CLRG-Series, High Tonnage Cylinders

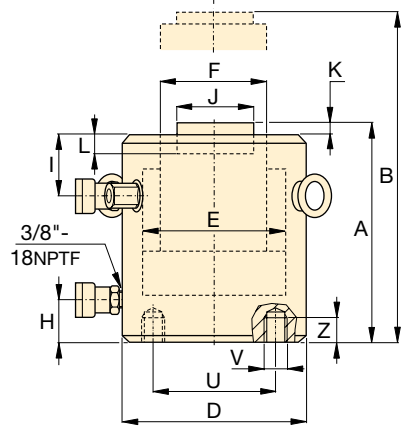
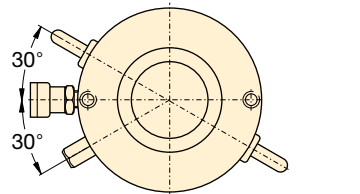

CLRG-50 to CLRG-150 models

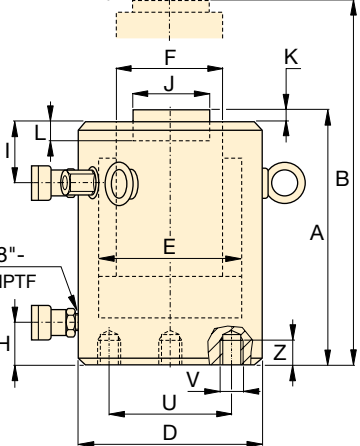
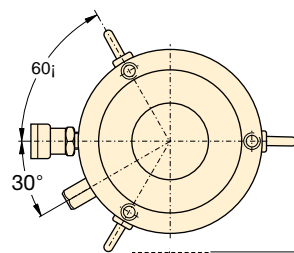

CLRG-200 to CLRG-1000 models

i **Speed Chart**
See the Enerpac Cylinder Speed Chart in our "Yellow Pages" section. **Page: 109**

◀ For full features see page 38.

Cylinder Capacity (tons) Nominal [maximum]	Stroke (in)	Model Number	Maximum Cylinder Capacity (tons)		Cylinder Effective Area (in ²)		Oil Capacity (in ³)	
			Push	Pull	Push	Pull	Push	Pull
50 [59]	1.97	CLRG-502	59	29	11.81	5.85	23.25	11.51
	3.94	CLRG-504	59	29	11.81	5.85	46.50	23.02
	5.91	CLRG-506	59	29	11.81	5.85	69.75	34.52
	7.87	CLRG-508	59	29	11.81	5.85	93.00	46.03
	9.84	CLRG-5010	59	29	11.81	5.85	116.25	57.54
	11.81	CLRG-5012	59	29	11.81	5.85	139.50	69.05
100 [103]	1.97	CLRG-1002	103	48	20.57	9.59	40.50	18.87
	3.94	CLRG-1004	103	48	20.57	9.59	81.00	37.74
	5.91	CLRG-1006	103	48	20.57	9.59	121.50	56.61
	7.87	CLRG-1008	103	48	20.57	9.59	162.00	75.49
	9.84	CLRG-10010	103	48	20.57	9.59	202.50	94.36
	11.81	CLRG-10012	103	48	20.57	9.59	242.99	113.23
150 [154]	1.97	CLRG-1502	154	75	30.78	14.96	60.58	29.44
	3.94	CLRG-1504	154	75	30.78	14.96	121.17	58.88
	5.91	CLRG-1506	154	75	30.78	14.96	181.75	88.32
	7.87	CLRG-1508	154	75	30.78	14.96	242.33	117.76
	9.84	CLRG-15010	154	75	30.78	14.96	302.92	147.20
	11.81	CLRG-15012	154	75	30.78	14.96	363.50	176.64
200 [206]	1.97	CLRG-2002	206	98	41.22	19.68	81.13	38.74
	5.91	CLRG-2006	206	98	41.22	19.68	243.40	116.23
	11.81	CLRG-20012	206	98	41.22	19.68	486.79	232.46
250 [284]	1.97	CLRG-2502	284	118	56.80	23.65	111.81	46.56
	5.91	CLRG-2506	284	118	56.80	23.65	335.42	139.69
	11.81	CLRG-25012	284	118	56.80	23.65	670.84	279.39
300 [354]	1.97	CLRG-3002	354	117	70.71	23.46	139.19	46.18
	5.91	CLRG-3006	354	117	70.71	23.46	417.56	138.55
	11.81	CLRG-30012	354	117	70.71	23.46	835.11	277.10
400 [434]	1.97	CLRG-4002	434	150	86.79	29.99	170.84	59.03
	5.91	CLRG-4006	434	150	86.79	29.99	512.51	177.09
	11.81	CLRG-40012	434	150	86.79	29.99	1025.02	354.18
500 [566]	1.97	CLRG-5002	566	192	113.25	38.37	222.92	75.54
	5.91	CLRG-5006	566	192	113.25	38.37	668.77	226.61
	11.81	CLRG-50012	566	192	113.25	38.37	1337.55	453.22
600 [663]	1.97	CLRG-6002	663	229	132.57	45.79	260.97	90.13
	5.91	CLRG-6006	663	229	132.57	45.79	782.90	270.39
	11.81	CLRG-60012	663	229	132.57	45.79	1565.81	540.79
800 [912]	1.97	CLRG-8002	912	300	182.32	59.99	358.91	118.09
	5.91	CLRG-8006	912	300	182.32	59.99	1076.72	354.28
	11.81	CLRG-80012	912	300	182.32	59.99	2153.44	708.57
1000 [1136]	1.97	CLRG-10002	1136	420	227.19	83.97	447.23	165.29
	5.91	CLRG-10006	1136	420	227.19	83.97	1341.68	495.87
	11.81	CLRG-100012	1136	420	227.19	83.97	2683.35	991.75

Base Mounting Hole Dimensions (in)			
Model / Capacity ton	Bolt Circle U	Thread Size V	Min. Thread Depth Z
CLRG-50	65	M12	12
CLRG-100	95	M12	12
CLRG-150	130	M12	12
CLRG-200	165	M12	12
CLRG-250	190	M12	12
CLRG-300	180	M16	30
CLRG-400	205	M16	30
CLRG-500	250	M24	36
CLRG-600	275	M24	36
CLRG-800	330	M24	36
CLRG-1000	375	M24	36

Double-Acting, High Tonnage Cylinders

* Optional Tilt Saddle

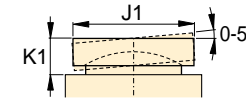

Capacity:
50-1,000 tons

Stroke:
1.97-11.81 inch

Maximum Operating Pressure:
10,000 psi

CLRG Series



Coll. Height A (in)	Ext. Height B (in)	Outside Dia. D (in)	Cyl. Bore Dia. E (in)	Plunger Dia. F (in)	Base to Advance Port H (in)	Top to Retract Port I (in)	Standard Saddle Dia. J (in)	Saddle Protr. from Plgr. K (in)	Depth of Plunger Hole L (in)	Weight (lbs)	Model Number	*Optional Tilt Saddle		
												Dia. J1 (in)	Height K1 (in)	Model Number
6.38	8.35	5.12	3.88	2.76	1.65	1.29	1.97	.04	.75	37	CLRG-502	1.97	1.69	CATG-50
8.35	12.28	5.12	3.88	2.76	1.65	1.29	1.97	.04	.75	44	CLRG-504	1.97	1.69	CATG-50
10.31	16.22	5.12	3.88	2.76	1.65	1.29	1.97	.04	.75	51	CLRG-506	1.97	1.69	CATG-50
12.28	20.16	5.12	3.88	2.76	1.65	1.29	1.97	.04	.75	60	CLRG-508	1.97	1.69	CATG-50
14.25	24.09	5.12	3.88	2.76	1.65	1.29	1.97	.04	.75	68	CLRG-5010	1.97	1.69	CATG-50
16.22	28.03	5.12	3.88	2.76	1.65	1.29	1.97	.04	.75	75	CLRG-5012	1.97	1.69	CATG-50
7.16	9.13	6.50	5.12	3.74	2.13	1.89	2.95	.04	.75	42	CLRG-1002	2.95	1.89	CATG-100
9.13	13.06	6.50	5.12	3.74	2.13	1.89	2.95	.04	.75	64	CLRG-1004	2.95	1.89	CATG-100
11.09	17.00	6.50	5.12	3.74	2.13	1.89	2.95	.04	.75	88	CLRG-1006	2.95	1.89	CATG-100
13.06	20.94	6.50	5.12	3.74	2.13	1.89	2.95	.04	.75	110	CLRG-1008	2.95	1.89	CATG-100
15.03	24.87	6.50	5.12	3.74	2.13	1.89	2.95	.04	.75	134	CLRG-10010	2.95	1.89	CATG-100
17.00	28.81	6.50	5.12	3.74	2.13	1.89	2.95	.04	.75	157	CLRG-10012	2.95	1.89	CATG-100
7.72	9.69	8.07	6.26	4.49	2.40	2.22	3.70	.04	.75	86	CLRG-1502	3.70	1.96	CATG-150
9.69	13.62	8.07	6.26	4.49	2.40	2.22	3.70	.04	.75	115	CLRG-1504	3.70	1.96	CATG-150
11.65	17.56	8.07	6.26	4.49	2.40	2.22	3.70	.04	.75	143	CLRG-1506	3.70	1.96	CATG-150
13.62	21.50	8.07	6.26	4.49	2.40	2.22	3.70	.04	.75	172	CLRG-1508	3.70	1.96	CATG-150
15.59	25.43	8.07	6.26	4.49	2.40	2.22	3.70	.04	.75	203	CLRG-15010	3.70	1.96	CATG-150
17.56	29.37	8.07	6.26	4.49	2.40	2.22	3.70	.04	.75	231	CLRG-15012	3.70	1.96	CATG-150
8.50	10.47	9.25	7.24	5.24	2.62	2.22	4.45	.04	.94	121	CLRG-2002	4.45	2.31	CATG-200
12.44	18.35	9.25	7.24	5.24	2.62	2.22	4.45	.04	.94	201	CLRG-2006	4.45	2.31	CATG-200
18.35	30.16	9.25	7.24	5.24	2.62	2.22	4.45	.04	.94	322	CLRG-20012	4.45	2.31	CATG-200
9.25	11.22	10.83	8.50	6.50	2.87	3.07	5.71	.04	.94	196	CLRG-2502	5.71	2.75	CATG-250
13.19	19.09	10.83	8.50	6.50	2.87	3.07	5.71	.04	.94	300	CLRG-2506	5.71	2.75	CATG-250
19.09	30.91	10.83	8.50	6.50	2.87	3.07	5.71	.04	.94	456	CLRG-25012	5.71	2.75	CATG-250
12.28	14.25	12.20	9.49	7.76	3.98	2.95	6.97	.04	.75	406	CLRG-3002	6.97	3.17	CATG-300
16.22	22.13	12.20	9.49	7.76	3.98	2.95	6.97	.04	.75	511	CLRG-3006	6.97	3.17	CATG-300
22.13	33.94	12.20	9.49	7.76	3.98	2.95	6.97	.04	.75	668	CLRG-30012	6.97	3.17	CATG-300
14.74	16.71	13.78	10.51	8.50	4.49	4.13	7.72	.12	1.06	595	CLRG-4002	7.72	3.06	CATG-400
18.68	24.59	13.78	10.51	8.50	4.49	4.13	7.72	.12	1.06	728	CLRG-4006	7.72	3.06	CATG-400
24.59	36.40	13.78	10.51	8.50	4.49	4.13	7.72	.12	1.06	928	CLRG-40012	7.72	3.06	CATG-400
16.50	18.46	15.75	12.01	9.76	4.49	5.31	8.98	.12	1.06	884	CLRG-5002	8.98	3.54	CATG-500
20.43	26.34	15.75	12.01	9.76	4.49	5.31	8.98	.12	1.06	1058	CLRG-5006	8.98	3.54	CATG-500
26.34	38.15	15.75	12.01	9.76	4.49	5.31	8.98	.12	1.06	1321	CLRG-50012	8.98	3.54	CATG-500
16.89	18.86	16.93	12.99	10.51	4.49	5.31	9.72	.12	1.06	1045	CLRG-6002	9.72	4.05	CATG-600
20.83	26.73	16.93	12.99	10.51	4.49	5.31	9.72	.12	1.06	1246	CLRG-6006	9.72	4.05	CATG-600
26.73	38.54	16.93	12.99	10.51	4.49	5.31	9.72	.12	1.06	1545	CLRG-60012	9.72	4.05	CATG-600
18.66	20.63	19.88	15.24	12.48	5.87	5.31	11.69	.12	1.06	1634	CLRG-8002	11.69	4.00	CATG-800
22.60	28.50	19.88	15.24	12.48	5.87	5.31	11.69	.12	1.06	1914	CLRG-8006	11.69	4.00	CATG-8